



Vermont Better Roads Grant Program



Cover Sheet

Please complete this page ONCE and return with your Grant Category Application(s)

Town/Organization: WILMINGTON

Primary Contact Person (Responsible for Signing Grant Agreement): SCOTT TUCKER

Title: TOWN MANAGER

Address: PO BOX 217, WILMINGTON, VT 05363

Street Address

Town

Zip

Primary Contact Person Email: MDIX@WILMINGTONVT.US; JDEFRANCESCO@WILMINGTONVT.US

Phone: (802) 464 -8591

SAM unique ID #: U69VY7BHJ6X4 Fiscal Year End Month (MM): 06

Admin email: JDEFRANCESCO@WILMINGTONVT.US

Road Foreman Name: MARSHALL DIX Road Foreman Email: MDIX@WILMINGTONVT.US



Vermont Better Roads Grant Program



CATEGORY B/C/D

Please complete one application per project you are applying for.

Please check the Category you are applying for:

- X B. Correction of a Road Related Erosion Problem and/or Stormwater Mitigation
- C. Correction of a Stream Bank, Lake Shore or Slope Related Problem
- D. Structure/culvert 36" diameter or greater

Municipality: WILMINGTON

Road Name: LAKE RAPONDA TH #: 4 Structure # (if applicable): _____

Road Type: Unpaved (select one) Road Class: 2

Please provide a thorough description of the erosion/water quality problem (ex. Roadway has steep slope with no ditch which is causing severe roadway erosion, which outlets into the Lamoille River): The current culvert is failing causing sink holes in the road and excessive sediment washing into the lake. The current culvert is also undersized for the amount of water run-off.

Has the town completed an MRGP compliant road erosion inventory?

- X Yes
- No
- In progress

Project Length (linear feet along roadway): 65 ft.

Number of structures/culverts replaced/repaired: 1

Average slope of roadway: X 0-5% 5-10% >10%

Provide a VERY detailed map of project location showing start and end points: X Included

Provide a sketch of project location showing distances and project details: X Included



Vermont Better Roads Grant Program



Environmental Concerns:

All projects require a review of potential impacts by our environmental team. To expedite the review process, please check the boxes below that describe existing structures/conditions to be replaced/maintained (if any) and the project description that applies (if any).

Existing Structures:	
<input checked="" type="checkbox"/> Steel/Plastic Culvert	<input type="checkbox"/> Concrete Box Culvert
<input type="checkbox"/> Stone Culvert – Take pictures	<input type="checkbox"/> Concrete Bridge
<input checked="" type="checkbox"/> Ditch	<input type="checkbox"/> Rolled Beam/Plate Girder Bridge
<input type="checkbox"/> Foundation remains, mill ruins, stone walls, other – Take pictures	<input type="checkbox"/> Stone abutments or piers – Take pictures
<input checked="" type="checkbox"/> Buildings within 300 feet of work - Take pictures	
Project Description:	
<input type="checkbox"/> New ditches will be established	<input checked="" type="checkbox"/> All work will be completed from the existing road or shoulder
<input checked="" type="checkbox"/> Reestablishing existing ditches only	<input type="checkbox"/> There will be excavation within 300 feet of a river or stream – Take pictures
<input checked="" type="checkbox"/> The structure is being replaced on existing location/alignment	<input type="checkbox"/> Road reclaiming, reconstruction, or widening
<input type="checkbox"/> Excavation within a floodplain – Take pictures	<input type="checkbox"/> Temporary off-road access is required
<input checked="" type="checkbox"/> Tree cutting/clearing – Take pictures	<input type="checkbox"/> The roadway will be realigned

Please describe the project and how it will create a positive water quality benefit (ex. Reshape 500' of ditch and line with 12 inch minus stone, to prevent sediment from entering the Lamoille River at the bottom of the hill):

Installing a 30" culvert with a drop inlet. The culvert will be installed deeper in the road so the outfall does not create a large plunge pool, also minimizing the amount of sediment into the lake. Installing riprap to stabilize the roadway.

Please list any professionals or partners that assisted with planning this project (ANR River Management Engineer, Army Corps of Engineers, VTrans staff, Basin Planner, RPC staff, etc.):

Josh Carvajal- ANR; Jeff Nugent; WRC

Is the project located in the town "Right of Way?" (select one) Yes No Both

Please be aware, Municipalities are required to have an Agreement for Entry & Liability Release for any impacted properties (prior to the start of construction.)



Vermont Better Roads Grant Program



Budget:

Please attach a project budget and confirm below that is attached:

Project budget IS attached

Are you applying to other grant programs to help fund this project? If so, what programs? Please note that Better Roads requires a 20% local match and Better Roads funding may not be used as match for other state or federally funded programs.

Requested Grant Amount:	\$ 20,000.00	Requested Grant Amount Max: \$20,000 Category B \$40,000 Category C \$60,000 Category D
+		
Local Match:	\$ 8,295.60	
=		
Total Project Cost:	\$ 28,295.60	See page 6 for more information on calculating match

Estimated Completion Date: 06/2025

REQUIRED ATTACHMENTS:

Please use the documentation checklist below to ensure that all of the relevant items regarding your application have been included. **It is preferred that your application is a single PDF file.**

- Grant application cover sheet
- Grant application form, including chart with RSID and MRGP compliance before and after project completion
- Itemized Cost estimate for labor, equipment, and materials (see enclosed Cost Estimate Worksheet). If applicable, please break down funding by source (i.e. different grant sources).
- Detailed Project Location Map
- Sketch of proposed project and erosion control measures or other management practices, including distances in feet
 - o Also show approximate location of town/other right-of-way and/or property lines and limits of work
- Photos must be color and clear to see.**
 - o **Please make sure there are enough photos to get a good idea of the project area**
- Other appropriate supporting documents.

By signing this application, I certify that all the information provided is accurate to the best of my knowledge. We will comply with all the requirements of the grant including making our books available for audit if required.

SIGNATURE OF APPLICANT:

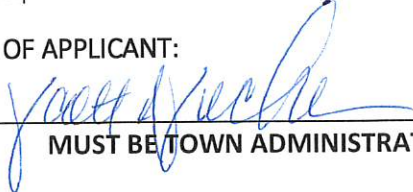
Name:  Title: 12-6-2023
MUST BE TOWN ADMINISTRATOR/MANAGER OR SELECT BOARD CHAIR



Vermont Better Roads Grant Program



River Management Engineer Support Letter

I am providing this letter of support to the Town/City/Village of WILMINGTON for their Better Roads grant application on LAKE RAPONDA ROAD, which will have an impact on TRIBUTARY TO LAKE RAPONDA.

Mile Marker, Road Name/TH Number

Name of River/Stream

Stream Alteration Permit Required for this project: Yes No

Upon review of the site, I have determined that the proposed project is eligible for a Stream Alteration Permit. Additionally, if this project is constructed according to the recommendations described below (see Comments), the following stream equilibrium and connectivity benefits will be achieved:

- Restores or enhances floodplain/access to floodplain
- Restores or enhances natural channel dimensions
- Establishes tree/shrub buffer
- Restores habitat (including aquatic organism passage)
- No additional benefits
- Further restricts or impacts the stream

Thank you for your consideration,

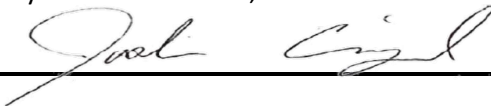

Signature

Comments:

BASED ON FIELD INSPECTION BY RME ON 11/06/2023:

- * CHANNEL INLET CULVERT SIZED TO ACTIVE CHANNEL WIDTH FOR INTERMITTENT STREAM
- * ACW RANGE OF 2-3FT AND DRAINAGE AREA OF 20 ACRES, UTILIZE 30" CULVERT FOR CHANNEL
- * OUTLET APRON TO BE MINIMUM OF VTRANS TYPE II STONE FILL, SEE BETTER ROADS MANUAL



LEGEND

- Bridges
- Culvert
- 100' Setback
- 250' Setback
- Wetland - VSWI**
 - Class 1 Wetland
 - Class 2 Wetland
 - Wetland Buffer
- Hazard Class**
 - High Hazard Potential
 - Significant Hazard Potential
 - Low Hazard Potential
 - Minimal Hazard Potential
 - Undetermined Hazard Potential
- Historical Dam Location
- DFIRM Floodways
- Flood Hazard Areas (Only FEM)**
 - AE (1-percent annual chance flood)
 - A (1-percent annual chance floodpl.
 - AO (1-percent annual chance zone feet)
 - 0.2-percent annual chance flood ha
- Parcels (standardized)
- Stream**
 - Stream
 - Intermittent Stream
- Roads**
 - Interstate

1: 2,435
November 6, 2023

124.0 0 62.00 124.0 Meters

WGS_1984_Web_Mercator_Auxiliary_Sphere 1" = 203 Ft. 1cm = 24 Meters

© Vermont Agency of Natural Resources THIS MAP IS NOT TO BE USED FOR NAVIGATION

NOTES

Map created using ANR's Natural Resources Atlas

DISCLAIMER: This map is for general reference only. Data layers that appear on this map may or may not be accurate, current, or otherwise reliable. ANR and the State of Vermont make no representations of any kind, including but not limited to, the warranties of merchantability, or fitness for a particular use, nor are any such warranties to be implied with respect to the data on this map.

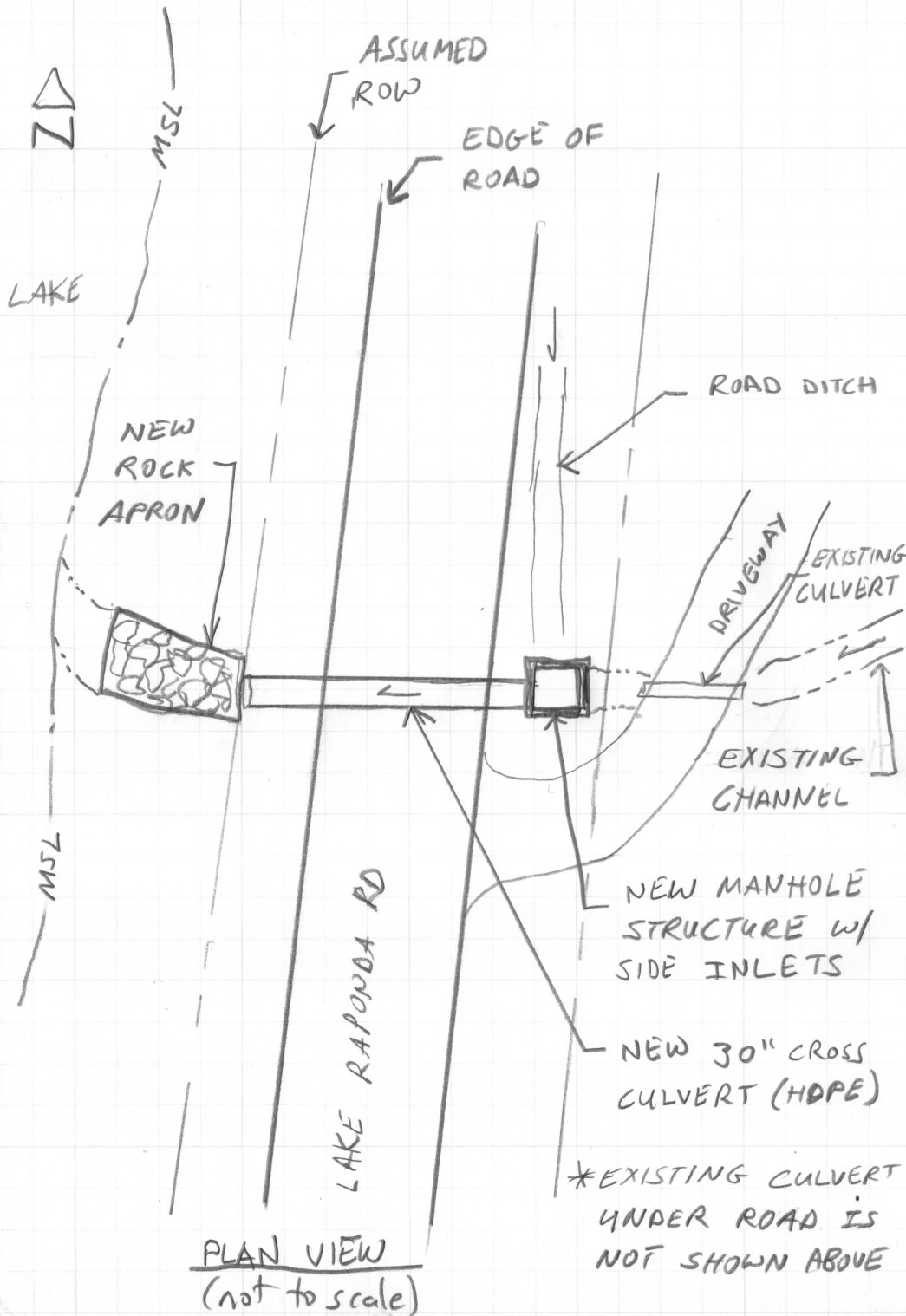

NOTE: CHANNEL DETERMINED TO BE INTERMITTENT BY RME

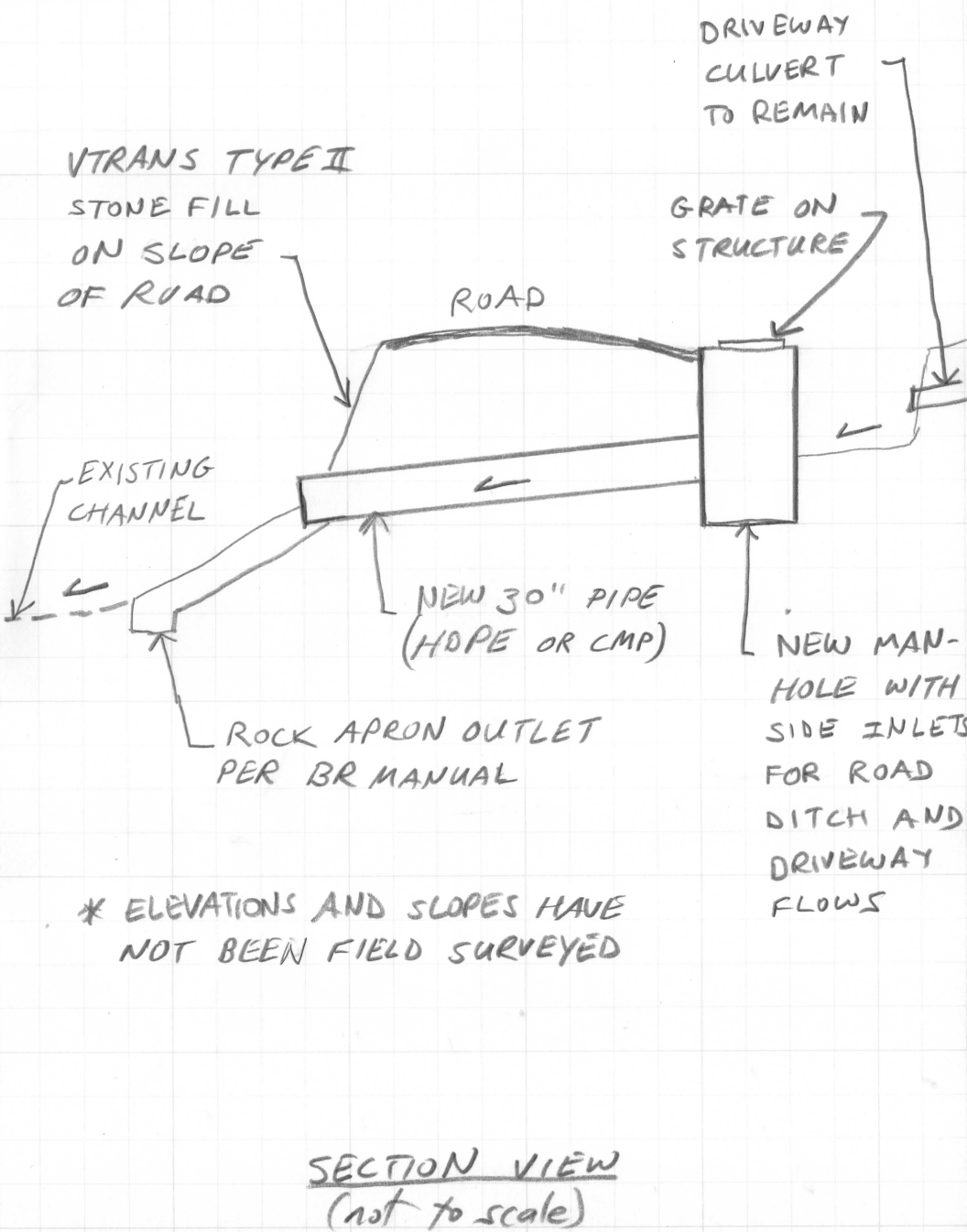

* ELEVATIONS AND SLOPES HAVE NOT BEEN FIELD SURVEYED







